

AKITA® JET

Patient Specific Inhalation with SMART CARD



AKITA® JET – Therapeutic control via SMART CARD

- ▶ Depending on individual lung function and medical condition, the patient can choose an inhalation time that suits their specific needs. The choice can be determined using the „Volume“ button on the AKITA® control unit.

Accommodating individual lung function

- ▶ The individual time of inhalation can be chosen from 10 different settings, ranging from 1.5 to 8.0 seconds per breath.

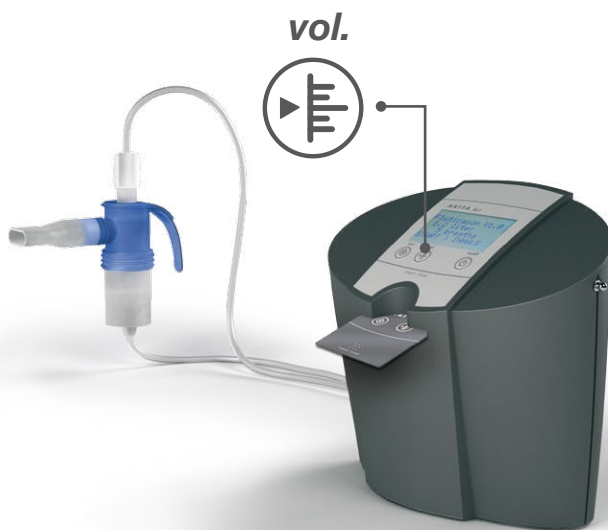

Loading the SMART CARD into the AKITA® control unit

An example of SMART CARD with dosing information on the antibiotic Colistin.

| | |
|----------------------|------------------------------------|
| Smart Card ID | 000991 |
| Language | English |
| Inhalations | 600 |
| Active agent | Colistin |
| Dosage | 1 Mio IE Colistin/ 2.5 – 3.0 ml |
| Deposition | Peripheral-alveolar |

| Inhalation time per breath | Total number of breaths |
|-----------------------------------|--------------------------------|
| 1.5 sec (0.3 l) | 84 |
| 2.0 sec (0.4 l) | 56 |
| 2.5 sec (0.5 l) | 46 |
| 3.0 sec (0.6 l) | 36 |
| 3.5 sec (0.7 l) | 33 |
| 4.0 sec (0.8 l) | 28 |
| 5.0 sec (1.0 l) | 21 |
| 6.0 sec (1.2 l) | 17 |
| 7.0 sec (1.4 l) | 14 |
| 8.0 sec (1.6 l) | 12 |

Options for patient-specific inhalation time per breath (corresponding inhalation volume will also be determined)

The number of breaths necessary to complete the therapy depends on the patient's chosen inhalation time

Determining individual inhalation time by measuring lung function

- ▶ Trial and error aside, it is also possible to measure lung function and use it as an indicator when determining personal inhalation time. According to predicted FEV₁ values, individual inhalation time can be calculated using the corresponding table of data.

AKITA® JET – Table of data detailing inhalation time per breath

| Severity grade – Corresponding to FEV ₁ (% of predicted) | | | | FEV ₁ related inhalation with AKITA® JET | |
|---|------------------------------|------------------------------|-----------------------------|---|-----------------------|
| 1 FEV ₁ > 80% | 2 FEV ₁ 50-80% | 3 FEV ₁ 30-50% | 4 FEV ₁ < 30% | Inhalation time per breath [sec] | Inhalation Volume [l] |
| FEV ₁ in [l] | FEV ₁ in [l] | FEV ₁ in [l] | FEV ₁ in [l] | | |
| 0.00 – 0.41 | 0.00 – 0.35 | 0.00 – 0.28 | 0.00 – 0.18 | - | - |
| 0.42 – 0.55 | 0.36 – 0.47 | 0.29 – 0.37 | 0.19 – 0.24 | 1.5 | 0.3 |
| 0.56 – 0.69 | 0.48 – 0.59 | 0.38 – 0.47 | 0.25 – 0.31 | 2.0 | 0.4 |
| 0.70 – 0.83 | 0.60 – 0.71 | 0.48 – 0.57 | 0.32 – 0.37 | 2.5 | 0.5 |
| 0.84 – 0.97 | 0.72 – 0.82 | 0.58 – 0.66 | 0.38 – 0.44 | 3.0 | 0.6 |
| 0.98 – 1.11 | 0.83 – 0.94 | 0.67 – 0.76 | 0.45 – 0.50 | 3.5 | 0.7 |
| 1.12 – 1.39 | 0.95 – 1.18 | 0.77 – 0.95 | 0.51 – 0.63 | 4.0 | 0.8 |
| 1.40 – 1.67 | 1.19 – 1.42 | 0.96 – 1.14 | 0.64 – 0.75 | 5.0 | 1.0 |
| 1.68 – 1.95 | 1.43 – 1.66 | 1.15 – 1.34 | 0.76 – 0.88 | 6.0 | 1.2 |
| 1.96 – 2.23 | 1.67 – 1.90 | 1.35 – 1.53 | 0.89 – 1.01 | 7.0 | 1.4 |
| >= 2.24 | >= 1.91 | >= 1.54 | >= 1.02 | 8.0 | 1.6 |

Inhalation time per breath for AKITA® JET

Corresponding inhalation volume



Activaero GmbH
Headquarters & Logistics

Wohraer Straße 37
 35285 Gemünden/Wohra
 Germany
 Tel. +49 (0)6453 64818-0
 Fax +49 (0)6453 64818-22

Service Hotline*
+49 (0)180 22 66 44 0

E-Mail
info@activaero.de

Internet
www.activaero.com

* 14 Cents per minute in Germany, prices can vary depending on mobile network